

**LAPIN AMK**<sup>7</sup>

Lapland University of Applied Sciences

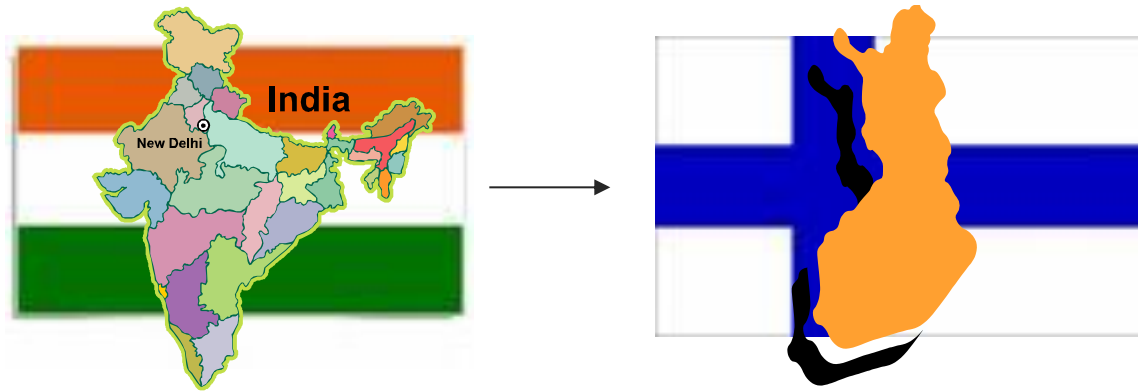

Teresa Chen

Ethnic Chinese

Born and raised in India

Living and working in Finland for 21 years

- Globalization and mobility a common scenario
- I am no exception to this phenomenon
- Reason: marriage

# How well does a person cope with an alien environment?

My story:

- From Kolkata to Tornio
- Multi-lingual
- Inexperienced and *starry-eyed*

# Culture shock and contrasts

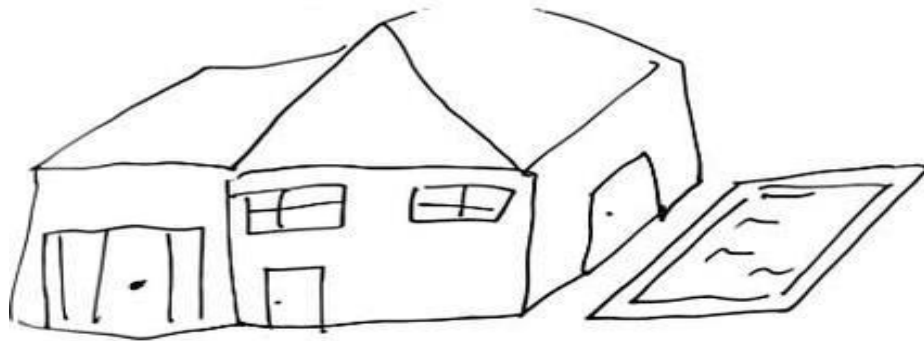

MY HOUSE

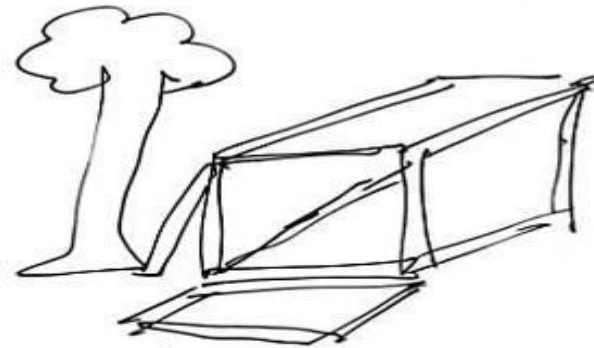

YOUR HOUSE



MY KIDS

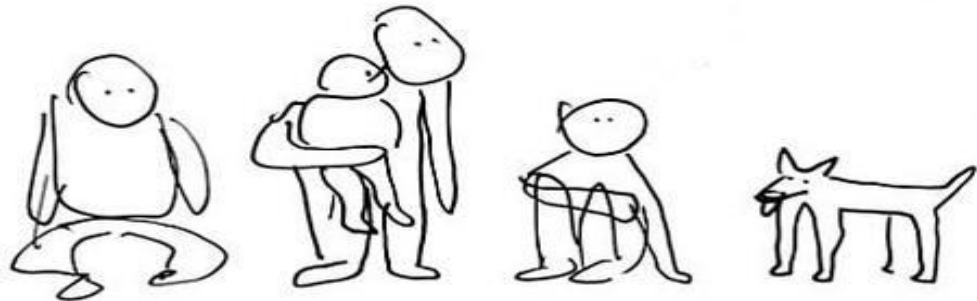

YOUR KIDS

Courtesy: Buena Vista pictures

- The Finnish silence and distance is pretty daunting
- Language belongs to Finno-Ugric group “second most difficult after Chinese”
- People ‘crazy Finn’



Courtesy: finland.fi

- Learning through trials and errors

- Social etiquette



Courtesy: Google Images

- Relationships and communication
- Environment and weather

# Challenges and consequences

- Loneliness and homesickness



Courtesy: Google Images



- Insights into a new culture and language
- Better understanding and tolerance of people in general
- Dispelling misconceptions
- Broadening of outlook – in spite of differences, people are similar
- Better appreciation of own culture

# Coping mechanism and motivation

- Family/Children
- Friends/Networking
- Work/Independence
- Religion
- Willingness to adapt
- Flexibility
- Learning to function under ambiguous circumstances, networking
- Biculturalism
- Personal desire to overcome the hurdles

# IMPORTANT - Integration of Internationalization in Studies - on campus experiences

- Polite
- Eager to join (projects or to communicate)
- "Friendly"
- Lying
- Gender disparity
- Age and seniority
- Wealth
- Signed agreement not seen as final deal

# Lapland UAS mobility

- Students/trainees : (3 months or more)
- incoming 107
- outgoing 183
- Teachers: (5 days or more)
- incoming 31
- outgoing 31
- Staff: ( 5 days or more)
- incoming 21
- outgoing 131
- Administrative and bureaucratic challenges of Erasmus+
- Late notification – language test
- International office staff burdened
- Teaching in English – a challenge
- Re-thinking of mobility - strategy
- Mobility beyond Europe

“The application should include: course description, syllabus, a brief justification on why your course is a perfect fit for the.....”

# THE NORTHERN FACTOR

**LAPIN AMK**<sup>7</sup>  
Lapland University of Applied Sciences

[www.laplanduas.fi](http://www.laplanduas.fi)